

# LHR SERIES-HIGH RATE

## LHR12560W (12V560W)

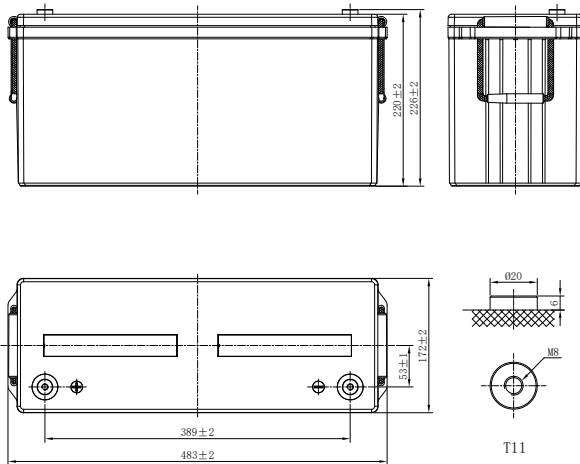

### CHARACTERISTICS

Item	Specifications	
Rated Voltage	12V	
Nominal Rate (25°C)	$W_{15}$ 1.67V/cell	560W/cell
Nominal Capacity (25°C)	$C_{10}$ 1.80V/cell	140Ah
Dimension	Length	483mm(19.0inches)
	Width	172mm(6.77inches)
	Container Height	220mm(8.66inches)
	Total Height	226mm(8.90inches)
Approx Weight	45.5kg(100.3lbs)	
Terminal	T11(M8)	
Container Material	ABS (UL94 HB or V-0 optional)	
Short-circuit current	2800A	
Internal Resistance (25°C)	Approx 3.5 mΩ (Fully charged)	
Operating Temp. Range	Discharge	-20~55°C (-4~131°F)
	Charge	-20~40°C (-4~104°F)
	Storage	-15~50°C (5~122°F)
Nominal Operating Temp. Range	25±3°C (77±5°F)	
Max.Charging Current (25°C)	0.25C	
Charge voltage (25°C)	Float Charge	Equalization Charge
	2.25-2.30V/cell	2.30-2.40V/cell
Temp. Coefficient	-3mV/cell/°C	-4mV/cell/°C
	40°C (104°F)	106%
Effect of temp. to Capacity	25°C (77°F)	100%
	0°C (32°F)	86%
	Self Discharge	≤ 3% per month at 25°C (77°F)

### DISCHARGE TABLE

Constant Current Discharge (Amperes) at 25°C (77°F)														
F.V/Time	5min	10min	15min	20min	30min	45min	1h	1.5h	2h	3h	4h	5h	8h	10h
1.85V/cell	334.8	265.9	227.7	181.4	125.2	96.0	77.1	56.6	46.3	34.5	27.2	23.0	15.9	13.6
1.80V/cell	380.7	301.8	258.1	205.0	141.2	101.9	79.7	58.3	49.0	35.6	28.3	24.0	16.3	14.0
1.75V/cell	413.6	327.3	279.4	221.4	151.9	107.8	83.0	60.7	50.9	36.4	29.2	24.6	16.4	14.1
1.70V/cell	442.1	349.0	296.7	234.7	161.0	113.3	86.6	63.2	52.1	37.2	29.9	25.2	16.7	14.2
1.67V/cell	457.5	360.0	311.0	241.1	164.9	114.5	87.6	64.9	53.3	38.0	30.3	25.5	16.9	14.4
1.60V/cell	473.7	372.3	320.6	247.3	168.9	117.3	89.2	67.1	54.4	38.9	31.0	26.0	17.0	14.5

Constant Power Discharge (Watts/cell) at 25°C (77°F)														
F.V/Time	5min	10min	15min	20min	30min	45min	1h	1.5h	2h	3h	4h	5h	8h	10h
1.85V/cell	625.2	500.2	431.2	345.0	239.3	184.6	149.2	109.7	90.0	67.3	53.4	45.4	31.6	27.1
1.80V/cell	699.4	559.5	482.4	385.9	267.7	194.6	153.3	112.4	94.8	69.2	55.2	47.0	32.2	27.8
1.75V/cell	746.5	597.2	514.8	411.8	285.7	204.7	158.9	116.5	98.1	70.5	56.9	48.2	32.4	27.9
1.70V/cell	784.7	627.8	541.2	433.0	300.4	213.6	165.0	120.8	100.0	71.8	58.0	49.1	32.9	28.1
1.67V/cell	797.5	638.0	560.0	440.0	305.3	214.7	165.9	123.3	102.0	73.1	58.6	49.6	33.2	28.4
1.60V/cell	808.7	646.9	567.8	446.2	309.5	217.9	167.7	126.6	103.3	74.5	59.6	50.4	33.3	28.6

# LHR SERIES-HIGH RATE

## LHR12560W (12V560W)



### APPLICATIONS

- UPS
- Hospitals and Testing Laboratories
- Emergency Power Supply
- Industrial Process Control Facilities
- Banks and Financial Markets
- Data and Network Operation Centers

### GENERAL FEATURES

- 12 years design life (25°C)
- Excellent high current performance - optimised for short discharge time
- Advanced AGM technology for superior high-rate power
- Long Life Alloy - minimizing grid growth, reducing gassing, and extending battery life
- Epoxy-sealed posts eliminate leaks
- Optimal energy density - saves floor space

### STANDARDS

- Compliance with IEC 60896 standards
- Classified as "Long Life" according to Eurobat
- CE, UL Approved
- Manufactured in Leoch@IATF 16949, ISO 45001, ISO 9001 and ISO 14001 certified production facilities

#### Discharge Characteristics

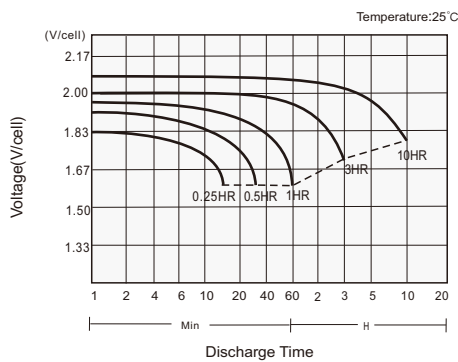

#### Charging Characteristics

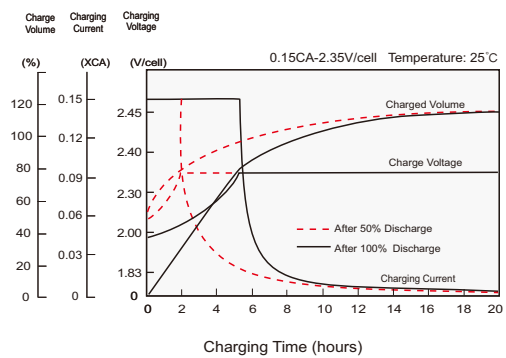

#### Effects of Temperature on Capacity

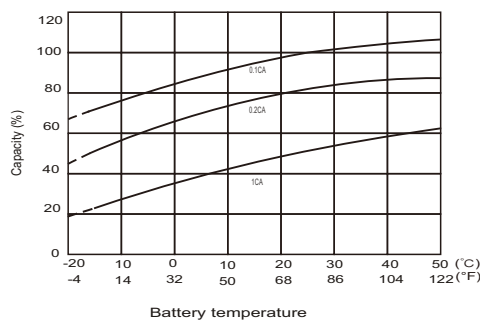

#### Self Discharge Characteristics

