

LP SERIES-GENERAL PURPOSE

LP12-180 (12V180Ah)

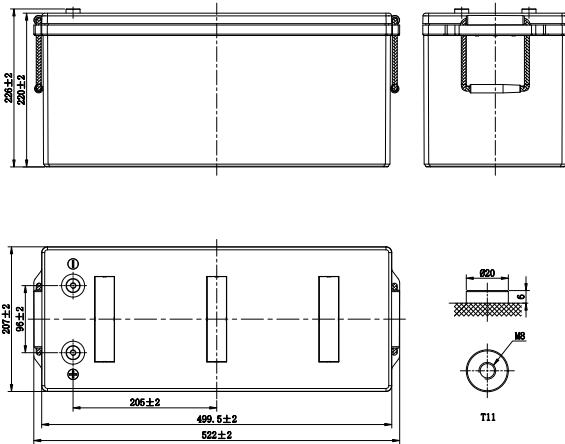

CHARACTERISTICS

Item	Specifications	
Rated Voltage	12V	
Nominal Capacity (25°C)	C ₁₀ , 1.80V/cell	180Ah
Dimension	Length	522mm (20.6inches)
	Width	207mm (8.15inches)
	Container Height	220mm (8.66inches)
	Total Height	226mm (8.90inches)
Approx Weight	50.3kg (110.9lbs)	
Terminal	T11(M8)	
Container Material	ABS (UL94 HB or V-0 optional)	
Short-circuit current	3600A	
Internal Resistance (25°C)	Approx 3.4 mΩ (Fully charged)	
Operating Temp. Range	Discharge	-15~50°C (5~122°F)
	Charge	-20~40°C (-4~104°F)
	Storage	-15~40°C (5~104°F)
Nominal Operating Temp. Range	25±3°C (77±5°F)	
Max. Charging Current (25°C)	0.3C	
Charge voltage (25°C)	Standby Use	Cycle Use
	2.25-2.30V/cell	2.35-2.40V/cell
Temp. Coefficient	-3mV/cell/°C	
	40°C (104°F)	103%
Effect of temp. to Capacity	25°C (77°F)	100%
	0°C (32°F)	86%
	≤3% per month at 25°C (77°F). LP series batteries may be stored up to 6 months at 25°C (77°F) and then a freshening charge is required. For higher temperatures the time interval will be shorter.	
Self Discharge		

DISCHARGE TABLE

Constant Current Discharge (Amperes) at 25°C (77°F)																
F.V/Time	5min	10min	15min	20min	30min	45min	1h	1.5h	2h	3h	4h	5h	6h	8h	10h	20h
1.85V/cell	268.9	253.9	230.9	181.6	162.4	124.7	100.6	72.9	61.3	44.9	35.3	30.6	27.0	20.7	17.2	9.12
1.80V/cell	304.8	288.2	261.6	205.3	176.9	132.2	104.2	75.4	63.3	48.8	37.6	32.2	29.0	21.8	18.0	9.45
1.75V/cell	329.9	312.6	283.2	221.6	180.5	136.9	109.3	79.2	66.6	49.7	38.3	32.8	29.2	21.9	18.2	9.54
1.70V/cell	350.4	333.3	300.8	235.0	184.1	139.7	111.5	80.8	67.9	50.7	39.0	33.3	29.4	22.3	18.4	9.64
1.67V/cell	360.5	343.8	309.6	241.4	186.8	141.7	113.1	82.0	68.9	51.2	39.6	34.0	29.5	22.6	18.6	9.76
1.60V/cell	371.8	355.6	319.2	247.6	189.5	143.8	114.8	83.2	69.9	51.7	40.1	34.5	29.7	22.9	18.8	9.88
Constant Power Discharge (Watts/cell) at 25°C (77°F)																
F.V/Time	5min	10min	15min	20min	30min	45min	1h	1.5h	2h	3h	4h	5h	6h	8h	10h	20h
1.85V/cell	590.1	477.7	437.2	345.3	310.4	233.0	183.5	133.2	107.3	79.1	69.2	60.3	53.3	41.2	34.2	18.2
1.80V/cell	660.2	534.3	489.0	386.3	335.3	245.2	202.1	144.9	110.2	85.4	73.6	63.1	57.0	43.2	35.7	18.8
1.75V/cell	704.6	570.3	521.9	412.3	339.5	252.5	208.4	148.8	115.6	86.8	74.7	64.0	57.3	43.3	36.1	19.0
1.70V/cell	740.7	599.5	548.7	433.4	343.4	255.8	214.9	152.9	117.4	88.2	75.7	64.9	57.5	43.9	36.4	19.1
1.67V/cell	752.7	609.3	557.6	440.5	345.8	258.1	218.3	155.0	118.6	88.6	76.6	66.0	57.6	44.4	36.8	19.3
1.60V/cell	763.4	617.8	565.4	446.7	347.3	259.4	223.5	158.6	122.3	89.0	77.2	66.6	57.8	44.9	37.2	19.5

LP SERIES-GENERAL PURPOSE

LP12-180 (12V180Ah)

APPLICATIONS

- All purpose
- Uninterruptable Power Supply (UPS)
- Electric Power System (EPS)
- Emergency backup power supply
- Alarm and security system
- Communication power supply
- DC power supply
- Auto control system

GENERAL FEATURES

- 10 years design life (25°C)
- Lead calcium alloy, sealed design, no watering required
- Puncture resistant micro-porous glass mat separators extend life
- Unique technology optimizes power capacity, cell consistency, and long-term reliability
- Designed for a wide range of applications

STANDARDS

- Compliance with IEC 60896 standards, EU Battery Directive
- UL, CE Approved
- Manufactured in Leoch@IATF 16949, ISO 45001, ISO 9001 and ISO 14001 certified production facilities

Discharge Characteristics

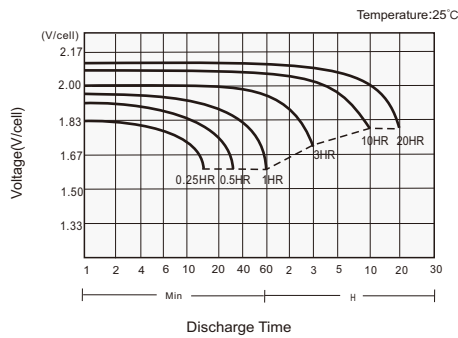

Charging Characteristics

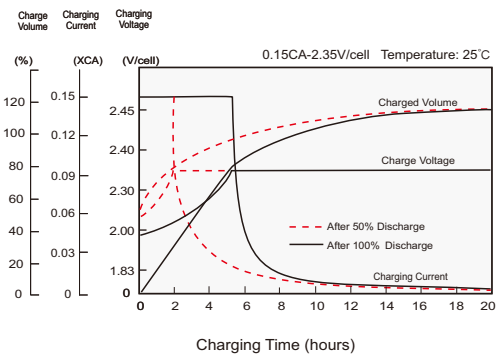

Effects of Temperature on Capacity

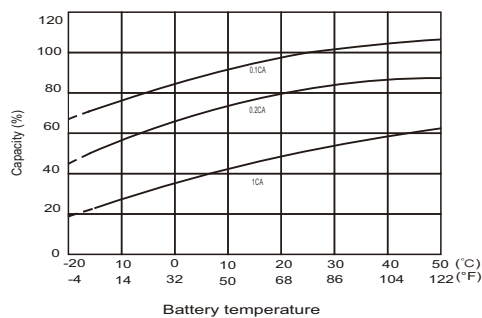

Self Discharge Characteristics

