

# PLX-PURE LEAD HIGH RATE

## PLX12-240 (12V240W)

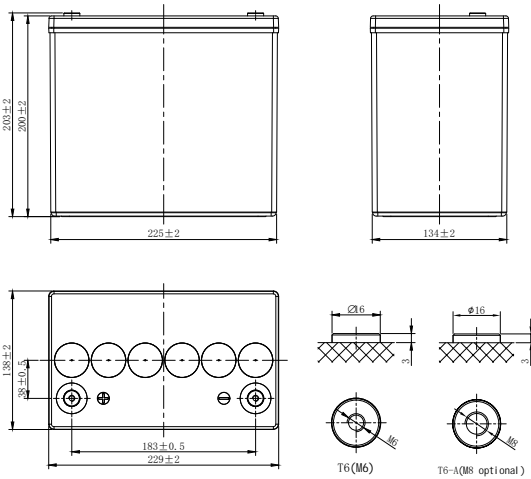

### CHARACTERISTICS

Item	Specifications	
Rated Voltage	12V	
Nominal Rate (25°C)	$W_{15}, 1.67V/cell$	240W/cell
Nominal Capacity (25°C)	$C_{10}, 1.80V/cell$	50Ah
Dimension	Length	229mm(9.02inches)
	Width	138mm(5.43inches)
	Container Height	200mm(7.87inches)
	Total Height	203mm(7.99inches)
Approx Weight	16.9kg(37.3lbs)	
Terminal	M6(M8 optional)	
Container Material	PC-ABS (UL94 V-0)	
Short-circuit current	1100A	
Internal Resistance (25°C)	Approx 5.8 mΩ (Fully charged)	
Operating Temp. Range	Discharge	-40~65°C (-40~149°F)
	Charge	-20~54°C (-4~129°F)
	Storage	-20~50°C (-4~122°F)
Nominal Operating Temp. Range	25±3°C (77±5°F)	
Max.Charging Current (25°C)	0.3C	
Charge voltage (25°C)	Float Charge	Equalization Charge
	2.27±0.02V/cell	2.35-2.40V/cell
Temp. Coefficient	-3mV/cell/°C	-4mV/cell/°C
	40°C (104°F)	103%
Effect of temp. to Capacity	25°C (77°F)	100%
	0°C (32°F)	86%
	Self Discharge	PLX series batteries can be stored up to 24 months at 25°C(77°F), For higher temperatures the time interval will be shorter.Battery needs to be given a freshening charge when the OCV approach 2.10V/cell or when the maximum storage time is reached, whichever occurs first.

### DISCHARGE TABLE

Constant Current Discharge (Amperes) at 25°C (77°F)															
F.V/Time	5min	10min	15min	20min	30min	45min	1h	1.5h	2h	3h	4h	5h	8h	10h	20h
1.85V/cell	195.2	138.1	106.0	90.1	68.0	50.0	38.5	25.8	19.5	13.4	10.3	8.56	5.86	4.88	2.51
1.80V/cell	210.1	147.2	113.2	95.1	71.1	52.0	40.0	26.8	20.3	13.7	10.7	8.83	6.02	5.00	2.61
1.75V/cell	241.1	162.3	123.2	101.0	75.0	53.0	42.1	28.4	21.5	14.4	10.9	9.02	6.14	5.10	2.67
1.70V/cell	260.1	172.2	130.1	108.0	77.1	55.1	43.1	28.8	21.6	14.5	11.1	9.22	6.27	5.18	2.72
1.67V/cell	279.3	182.1	135.0	109.1	79.1	56.0	43.5	29.3	22.1	14.9	11.3	9.39	6.38	5.29	2.77
1.60V/cell	295.4	189.2	141.1	111.0	80.0	57.1	44.0	29.5	22.3	15.0	11.6	9.61	6.55	5.41	2.84
Constant Power Discharge (Watts/cell) at 25°C (77°F)															
F.V/Time	5min	10min	15min	20min	30min	45min	1h	1.5h	2h	3h	4h	5h	8h	10h	20h
1.85V/cell	358.6	275.8	215.2	175.2	117.6	91.6	73.7	50.8	39.2	28.8	22.2	18.4	12.7	10.7	5.48
1.80V/cell	390.4	285.7	222.8	183.3	142.1	102.3	76.6	52.4	40.3	29.4	22.7	18.9	12.8	10.8	5.67
1.75V/cell	455.8	305.0	231.8	194.0	149.3	106.4	80.1	54.4	41.8	30.4	23.1	19.4	13.0	11.0	5.77
1.70V/cell	481.5	315.4	239.1	199.5	153.4	108.9	82.7	55.7	42.7	31.0	23.5	20.2	13.3	11.1	5.84
1.67V/cell	500.1	325.0	240.0	200.9	156.0	110.4	83.0	56.5	43.2	31.5	24.0	20.3	13.4	11.3	5.92
1.60V/cell	515.0	330.2	245.8	204.4	157.6	111.6	84.1	57.3	43.9	31.6	24.2	20.4	13.7	11.3	6.00

# PLX-PURE LEAD HIGH RATE

## PLX12-240 (12V240W)



### APPLICATIONS

- UPS
- Emergency lighting
- Emergency Power supply
- Electric starting
- Power tools

### GENERAL FEATURES

- 15 years design life (25°C)
- Utilizes pure lead technology, thin positive grids and unique manufacturing process to maximize corrosion resistance and service life while increasing energy density
- Specifically designed for high-rate discharge applications
- Wide Wpc range of front and top terminal monoblocs
- UL 94 V-0 Case and cover heat sealed and 100% tested to prevent leaks

### STANDARDS

- Compliance with IEC 60896 standards
- Classified as "Very Long Life" according to Eurobat
- CE,UL Approved
- Manufactured in Leoch@IATF 16949, ISO 45001,ISO 9001 and ISO 14001 certified production facilities

#### Discharge Characteristics

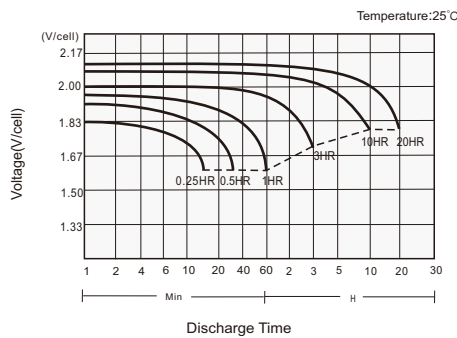

#### Charging Characteristics

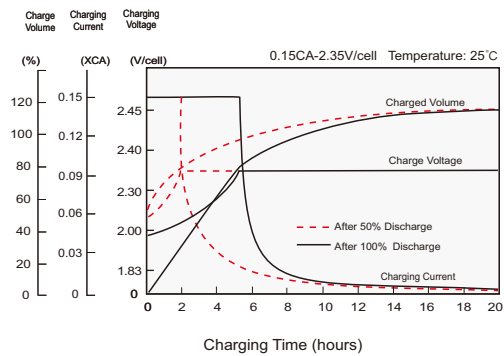

#### Effects of Temperature on Capacity

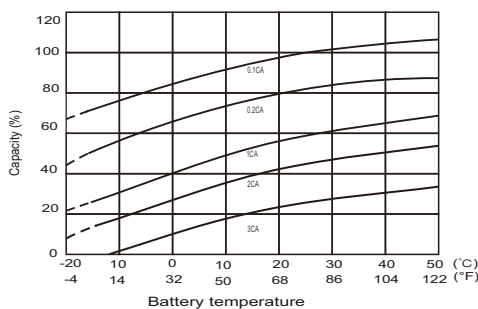

#### Self Discharge Characteristics

