

PLX-PURE LEAD HIGH RATE

PLX12-405 (12V405W)

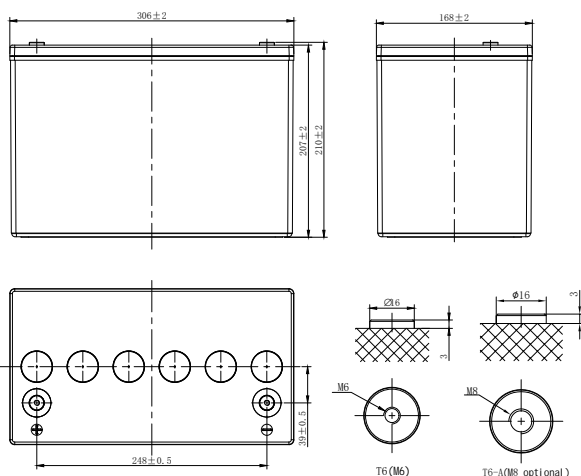

CHARACTERISTICS

Item	Specifications	
Rated Voltage	12V	
Nominal Rate (25°C)	$W_{15}, 1.67V/cell$	405W/cell
Nominal Capacity (25°C)	$C_{10}, 1.80V/cell$	92.8Ah
Dimension	Length	306mm(12.0inches)
	Width	168mm(6.61inches)
	Container Height	207mm(8.15inches)
	Total Height	210mm(8.27inches)
Approx Weight	30.1kg(66.4lbs)	
Terminal	M6(M8 optional)	
Container Material	PC-ABS (UL94 V-0)	
Short-circuit current	2041.6A	
Internal Resistance (25°C)	Approx 4.0 mΩ (Fully charged)	
Operating Temp. Range	Discharge	-40~65°C (-40~149°F)
	Charge	-20~54°C (-4~129°F)
	Storage	-20~50°C (-4~122°F)
Nominal Operating Temp. Range	25±3°C (77±5°F)	
Max.Charging Current (25°C)	0.3C	
Charge voltage (25°C)	Float Charge	Equalization Charge
	2.27±0.02V/cell	2.35-2.40V/cell
Temp. Coefficient	-3mV/cell/°C	
	-4mV/cell/°C	
Effect of temp. to Capacity	40°C (104°F)	103%
	25°C (77°F)	100%
	0°C (32°F)	86%
Self Discharge	PLX series batteries can be stored up to 24 months at 25°C(77°F), For higher temperatures the time interval will be shorter. Battery needs to be given a freshening charge when the OCV approach 2.10V/cell or when the maximum storage time is reached, whichever occurs first.	

DISCHARGE TABLE

Constant Current Discharge (Amperes) at 25°C (77°F)															
F.V/Time	5min	10min	15min	20min	30min	45min	1h	1.5h	2h	3h	4h	5h	8h	10h	20h
1.85V/cell	291.6	232.2	194.4	164.7	119.7	89.4	68.5	46.7	37.0	27.2	20.5	17.2	11.3	9.14	4.59
1.80V/cell	312.0	243.0	201.6	170.1	123.8	90.7	69.3	47.5	37.8	27.4	20.7	17.5	11.4	9.28	4.68
1.75V/cell	353.0	258.0	211.0	176.0	129.0	94.0	71.1	49.0	38.6	27.8	21.2	17.8	11.5	9.41	4.73
1.70V/cell	391.0	275.0	220.0	180.0	134.0	95.0	72.9	49.7	39.1	28.1	21.6	17.9	11.6	9.49	4.77
1.67V/cell	421.0	286.0	226.0	184.0	136.0	96.0	73.7	50.2	39.4	28.3	22.1	18.0	11.7	9.56	4.82
1.60V/cell	443.0	295.0	231.0	188.0	139.0	97.0	74.7	50.7	39.7	28.5	22.5	18.2	11.8	9.61	4.86
Constant Power Discharge (Watts/cell) at 25°C (77°F)															
F.V/Time	5min	10min	15min	20min	30min	45min	1h	1.5h	2h	3h	4h	5h	8h	10h	20h
1.85V/cell	576.1	429.5	368.0	302.1	230.1	171.1	130.2	91.1	73.5	54.2	40.8	34.8	22.0	18.3	9.27
1.80V/cell	600.4	456.4	383.7	314.6	237.0	174.3	131.1	92.0	75.0	54.8	41.2	35.0	22.2	18.6	9.45
1.75V/cell	660.5	487.7	392.7	332.8	249.2	178.5	135.0	93.9	76.4	55.3	41.5	35.2	22.3	18.7	9.65
1.70V/cell	715.7	507.6	396.8	340.0	255.1	180.2	136.5	95.0	77.0	55.7	41.9	35.7	22.4	19.0	9.73
1.67V/cell	760.5	522.0	405.0	342.1	256.5	182.1	137.6	96.0	77.7	56.0	42.5	36.1	23.2	19.1	9.77
1.60V/cell	792.6	552.9	419.0	344.1	258.1	184.2	138.7	96.5	78.0	56.3	42.5	36.3	23.5	19.2	9.80

PLX-PURE LEAD HIGH RATE

PLX12-405 (12V405W)



APPLICATIONS

- UPS
- Emergency lighting
- Emergency Power supply
- Electric starting
- Power tools

GENERAL FEATURES

- 15 years design life (25°C)
- Utilizes pure lead technology, thin positive grids and unique manufacturing process to maximize corrosion resistance and service life while increasing energy density
- Specifically designed for high-rate discharge applications
- Wide Wpc range of front and top terminal monoblocs
- UL 94 V-0 Case and cover heat sealed and 100% tested to prevent leaks

STANDARDS

- Compliance with IEC 60896 standards
- Classified as "Very Long Life" according to Eurobat
- CE,UL Approved
- Manufactured in Leoch@IATF 16949, ISO 45001,ISO 9001 and ISO 14001 certified production facilities

Discharge Characteristics

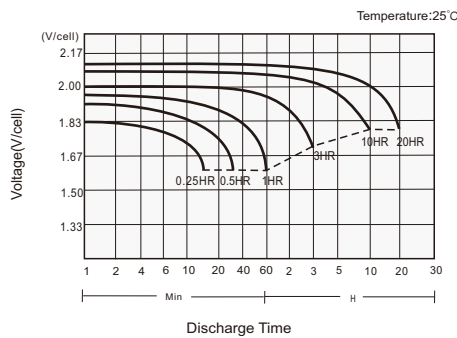

Charging Characteristics

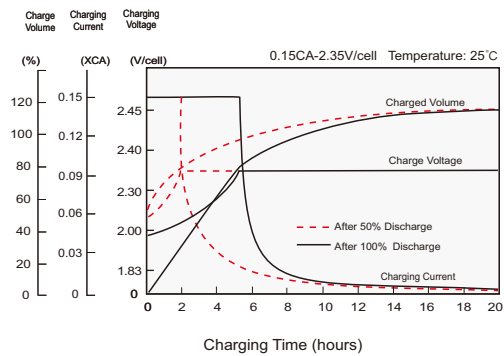

Effects of Temperature on Capacity

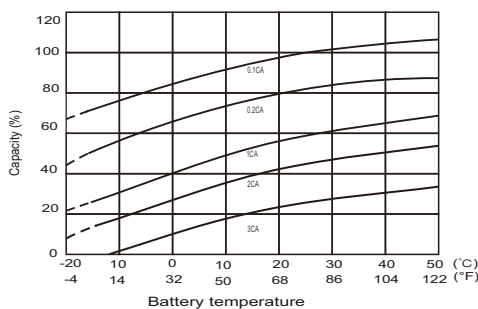

Self Discharge Characteristics

